



CERAMIC & GLASS



REP-0409



Each Reproduction a Masterpiece With Flexbar *Reprorubber*® Impressions

Flexbar *Reprorubber* is the state-of-the-art metrology-grade, self-curing casting material. Now it's faster and easier to create virtually perfect replicas of both internal and external forms. Offered in three different viscosities, *Reprorubber* kits produce quick "zero shrinkage" reproductions in less than 10 minutes. *Reprorubber* flawless castings make it simple to check internal and external forms for non-destructive inspection and to measure for accuracy – even in hard-to-access part dimensions and surface finish geometrics.

• Flexbar Flexibility

Reprorubber sets the standards for simplicity and versatility. The easy-to-mix, two-part base/catalyst system comes in three viscosities:

1. *Reprorubber* Thin Pour (Light Green) – for internal forms requiring superior flow and detail.
2. *Reprorubber* Medium Body (Orange) – for both internal and external applications.
3. *Reprorubber* Quick Setting Putty (Light Blue) – for internal and external applications and with the ability to withstand temperatures of 600° F (315.5° C) or more.

• Convenient Pre-Filled Cartridges Also Available

The Repro Mix II Quick Dispense Cartridge System eliminates manual mixing. A dual barrel, reusable, rugged dispensing gun utilizes pre-filled *Reprorubber* cartridges in Thin Pour and Medium Orange viscosities. Disposable helix mixing nozzles can be used for each application, making the system waste-free and even more convenient to use.

• Unduplicated Benefits

Reprorubber offers numerous advantages over other hard-copy replicating materials:

- Quick casting – zero shrinkage
- No release agent required — will not stick to part.
- Surface finish replication is exact with excellent optical properties easily checked on an optical comparator or video inspection machine.
- Copies can be recopied from original mold.
- Replicas are permanent – will not leach out, ooze out, or outgas.
- No more 16 hour cure time as with RTV silicones.
- More accurate than all other RTV compounds.

• Industrial Applications

- Metalworking
- Automotive
- Aerospace
- Oil & Gas
- Medical Devices
- Plastics
- Sheet Metal & Stampings
- Forensics
- Art Restorations
- More

Flexbar *Reprorubber*® Self-Curing Formula — For the Measure of Perfection

Reprorubber – the easy metrology casting material:

- Easy to use convenient kits in 3 viscosities.
- Easy to mix non-toxic materials.
- Easy to remove the replica from the mold.
- Easy to cross-section with knife or razor.
- Easy to inspect internal & external forms.
- Easy to check on optical scanner or microscope.





Original Reprorubber® Thin Pour

Final Color - LIGHT GREEN

For internal-shape applications where a thin pour will completely fill the cavity without voids. A complete replica casting is quickly formed.

- Manipulation time is approximately 2 minutes and cure time is approximately 10 minutes.
- Start to finish: approximately 12 minutes.
- Kits include graduated mixing cups, wooden spatulas and instructions.



New Reprorubber® Orange - Medium Body Prefilled Cartridges

Final Color - ORANGE

New Medium Body (Medium Viscosity - Medium Durometer) casting material ideal for both internal and external applications. Disposable

prefilled dual barrel 50ml cartridges can quickly dispense casting material utilizing the REPRO-MIX II Gun System.

- Mix time: 15-30 seconds and cure time is 5-6 minutes.
- Start to finish: 6-8 minutes.

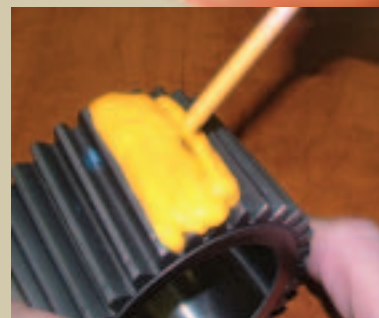

New Reprorubber® Thin Pour Prefilled Cartridges

Final Color - LIGHT GREEN

Same viscosity and durometer as Original Reprorubber Thin Pour. Disposable prefilled dual barrel 50ml cartridges can quickly mix and dispense casting material

utilizing the REPRO-MIX II Gun System. For internal-shape applications where a thin pour will completely fill the cavity without voids. A complete replica casting is quickly formed.

- Cure time is approximately 10 minutes.
- Start to finish: approximately 12 minutes.



Original Reprorubber® Quick Setting Putty

Final Color - LIGHT BLUE

Roll two equal-sized balls of catalyst putty and base putty and simply knead them together like dough. Excellent for external shapes. Simply spread over master, pushing down with fingers, and wait for cure 8-10 minutes.

You have 1 or 2 minutes of manipulation time, therefore 12 minutes start to finish.

You can also cast internal shapes and cavities but some pressure should be applied such as a weighted object on top.



FLEXBAR Metrology Casting Material

ORDERING INFORMATION — ORIGINAL MIX YOUR OWN KITS

Original *Reprorubber*® Thin Pour Final Color - LIGHT GREEN

Trial Size Kit:

Order No. 16116 Thin Pour 130ml Trial Kit

Standard Size Kits:

Order No. 16135 Thin Pour 380ml Kit

Order No. 16137 Case of 10 each 380ml Kits



Original *Reprorubber*® Quick Setting Putty Final Color - LIGHT BLUE

Trial Size Kit:

Order No. 16129 220ml Quick Setting Putty Trial Kit

Other Kits:

Order No. 16130 1³/₄ lb. (520ml) Introductory Kit

Order No. 16131 7 lb. (2150ml) Economy Kit



Quick Dispense Cartridge System Kits

Reprorubber Quick Dispense Cartridge System Kits contain everything you need to easily create Highly Accurate, Zero Shrinkage replicas. Each kit includes 1 each *Repro-Mix II* Reusable Dispensing Gun, 6 each 50ml Prefilled *Reprorubber* Disposable Cartridges, 15 Disposable Mixing Nozzles, 2 Micro Injector Snap-On Nozzles, and a Deluxe Fitted Carrying Case.



Kit No. 16305

Reprorubber Orange
Also Available (see below)
Thin Pour (Green) and
Combo Kits.



No. 16301 Green



No. 16306 Orange

Low cost, disposable
mixing nozzle
tips allow multiple
applications.



Snap-on Micro Inject
Nozzle (optional) for
small holes and cavities

ORDERING COMPLETE KITS:

No. 16300 *Reprorubber* Thin Pour (Green)
Quick Dispense Cartridge System
Kit Complete.

No. 16305 *Reprorubber* Orange (Medium Body)
Quick Dispense Cartridge System
Kit Complete.

No. 16309 *Reprorubber* Combo Quick
Dispense Cartridge System Kit,
Includes 3 each Thin Pour & 3
each Orange.

SYSTEM REFILLS:

No. 16301 *Reprorubber* Thin Pour (Green) 50ml Cartridge, 1 each.

No. 16302 *Reprorubber* Thin Pour (Green) 50ml Cartridges, 6 pack.

No. 16306 *Reprorubber* Orange (Medium Body) 50ml Cartridge, 1 each.

No. 16307 *Reprorubber* Orange (Medium Body) 50ml Cartridges, 6 pack.

No. 16311 *Repro-Mix II* Dispensing Gun (reusable).

No. 16313 *Repro-Mix II* Helix Mixing Nozzles, 15 Pack.

No. 16316 *Repro-Mix II* Helix Mixing Nozzles, 100 Pack.

No. 16315 Quick Dispense Cartridge System Fitted Case (without contents).

No. 16314 Micro Injector Snap-On Nozzle, Pack of 15.

PHYSICAL PROPERTIES AND APPLICATIONS

	REPRORUBBER THIN POUR	REPRORUBBER MEDIUM BODY ORANGE	REPRORUBBER QUICK SETTING PUTTY
Mix Time	15-30 seconds	15-30 seconds	Approximately 1 minute
Working Time (Manipulation Time)	2 minutes	2.5 minutes	1-2 minutes (from beginning of mix)
Setting Time (at room temperature)	10-15 minutes	5-6 minutes	8-10 minutes
Permanent Deformation	0.2%	0.3%	0.3%
Dimensional Stability	Less than 0.50%	Less than 0.40%	Less than -0.25%
Tear Strength	44psi	300psi	105psi
Elongation	60% at break	70% at break	6.3% at break
Durometer (Shore A-2)	30 (at 15 minutes)	40 (at 10 minutes)	50 (at 7 minutes)
Temperature Stability	1 week @ 23°C (72°F)	1 week @ 23°C (72°F)	1 week @ 23°C (72°F)
Detail Reproduction	EXCELLENT	EXCELLENT	EXCELLENT

APPLICATIONS

You can take impressions of:

- **ALL METALS**
- **NON METALS**
- **PAPER OR CARDBOARD ITEMS**
- **WOOD, MARBLE, ETC.**
- **ALL PLASTICS**
- **RUBBER**
- **CERAMIC AND GLASS ITEMS**

Other Uses Include:

- Prototypes of rubber type components such as gaskets, washers, etc.
- Making joints where flexibility is required.
- As a mask for high temperature plasma spray of metallic coatings.
- Fixturing where semi-rigid structure is desired.

PHYSICAL ADVANTAGES OVER THE HARD-COPY REPLICAS

- Replica is easy to remove – even if there are under cuts or grooves.
- Cross-sectioning of replica is easily accomplished with a knife or razor.
- It can then be checked on an optical comparator or microscope.
- Surface finish replication is exact with excellent optical properties.
- *Reprorubber* copies can be recopied (copy from a “female mold” yields a male-shaped replica).
- Replicas are permanent – will not leach out, ooze out, or outgas.
- NO MORE 16 HOUR CURE TIME AS WITH RTV SILICONES.
- MORE ACCURATE THAN ALL OTHER RTV COMPOUNDS.
- *REPRORUBBER* PUTTY will withstand up to 600°F (or more).

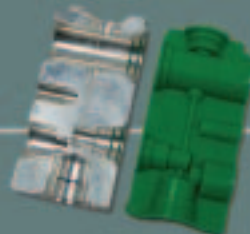
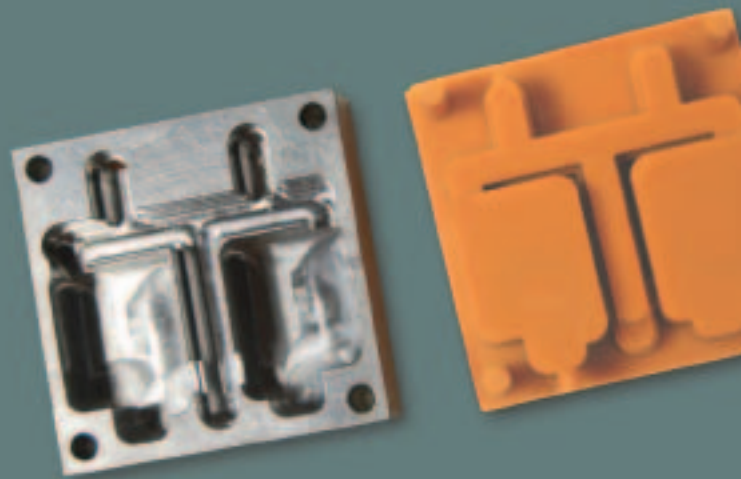

For additional information and applications, please visit our website, www.reprorubber.com.